

• **Mixing and dosing unit**  
**Sidomix**



• **SERVICE MANUAL**

**Dear customer,**

Thank you for choosing a product from the Wassermann range. Wassermann Dental-Maschinen incorporates the highest standards of quality and the latest technology.

In order to enjoy maximum performance and years of trouble-free operation, please read this service manual carefully before you connect this device and start work, and operate the device according to the recommended guidelines. The operation safety and the functionality of this device can only be guaranteed if you follow both the general safety guidelines and the applying laws to prevent accidents as well as the precautions given in this service manual. We are not liable for any damages which occur due to inappropriate usage or faulty operation of this device.



Make sure that anyone using this device has read and understood this service manual.

**Keep this service manual in a safe place where it can be referred to as required at any time.**

**Company address:**

Wassermann Dental-Maschinen GmbH

Rudorffweg 15-17

D-21031 Hamburg, Germany

Phone. : +49 (0)40 / 730 926 – 0 Fax.: +49 (0)40 / 730 37 24

E-mail: [info@wassermann-dental.com](mailto:info@wassermann-dental.com)

**URL: <http://www.wassermann-dental.com>**

## Contents

1 Features .....	4
2 Safety guidelines.....	5
2.1 Safety symbols used in this manual.....	5
2.2 Safety guidelines.....	6
2.3 Responsibility for operation or damage.....	7
3 Application .....	7
4 Before starting.....	7
4.1 Transport.....	7
4.2 Installation.....	8
4.3 Storage.....	8
5 Installation / Start-up .....	8
5.1 When using 2 litre material containers (included): .....	9
5.2 When using 1 kg bottles:.....	9
5.3 When using 6 kg bulks:.....	9
5.4 When using 25 kg bulks:.....	10
5.5 Replacing bottles/cans:.....	10
6 Operation.....	11
6.1 General operating instructions.....	11
7 Troubleshooting.....	13
8 Care and maintenance.....	14
8.1 Cleaning.....	14
8.2 Maintenance.....	14
8.3 Repairs.....	14
8.4 Spare parts.....	15
8.5 Scope of delivery / Accessories.....	15
8.6 Warranty .....	15
9 Technical data.....	16
10 EC Conformity Certificate.....	17
11 Spare part diagram.....	18
12 Wiring diagram.....	19

## 1 Features

Mixing and dosing of addition-vulcanizing 1:1 two-component silicones. For even dosage of both components, both must have similar viscosity.

### **Advantages:**

- Mixing head with separate output openings – mixing of A and B components while mounting or dismounting the mixing cannula is impossible
- Automatic production of homogeneous silicone material without any loss or bubbles at the press of a button
- Saves material and time by filling more than one bowl at the same time with just a single mixing cannula
- Forced mixing by a disposable mixing cannula, pink with bayonet mount
- Containers with quick couplings mounted directly on the device
- Quick coupling for mounting of 1 kg and 6 kg (optional adapter set ) or 25 kg (optional pad stand and adapter set with connection hoses required).
- The included 2x2 litre material containers feature a quick coupling and can be used immediately.
- Food switch available as option

## 2 Safety guidelines

### 2.1 Safety symbols used in this manual



#### **Warning!**

This is a warning of risk situations and dangers.

Failure to observe this warning could be life-threatening. These warnings has to be observed.



#### **Information!**

This symbol draws your attention to specific features that has to be observed.

## 2.2 Safety guidelines

Configuring and operating this equipment requires **precise knowledge** and **observance** of the instructions in this **service manual**. The equipment is designed only for its intended application.



**WARNING:**

Servicing and repairs should be carried out only by authorised specialists.  
Disconnect the power plug before starting any maintenance work.



Make sure that the equipment is connected to the correct power source.



Always keep the two silicone components separated – never mix up the connections! The mixing of components would cause the silicone within the device to harden, making extensive repairs of the device in the Hamburg plant necessary.

Drill a ventilation hole using a drill or similar tool at the upper side edge of the 1 litre bottle or 6 kg or 25 kg can. Do not tighten the caps of the 2 litre material containers, but just fit them loosely to ensure proper ventilation.

After hardening and before further usage, fit a new mixing cannula.

**WARNING: Never use with a hardened mixing cannula!**

Note that while using bulk containers, the cans must be positioned at a height higher than the device. Optional pad stands are available on request.

Leave about 2-3 cm minimal filling inside the containers to avoid air to get into the system and the need for demanding bleeding of the device.

## 2.3 Responsibility for operation or damage

The responsibility for operating the device lies exclusively with the owner or user if said device is incorrectly serviced, maintained or altered by persons not employed by an authorised dealer or if the device is used in a manner contrary to its specified purpose.

The unit has to be maintained and operated in accordance with this service manual. Wassermann Dental-Maschinen GmbH is not responsible for damage arising from the **nonobservance** of these instructions.

Warranty and responsibility provisions contained in the sales and supply conditions of Wassermann Dental-Maschinen GmbH are not extended by these instructions.

## 3 Application

Mixing and dosing of addition-vulcanizing 1:1 two component silicones.

For even dosage of both components, both must have similar viscosity.

Only use the device for this type of application.

## 4 Before starting

### 4.1 Transport

Before transporting the unit, ensure that it has been unplugged from the power socket. Make sure that it is packed correctly in order to avoid accidental damage.



Be sure to check for any transport damage when unpacking the goods. Note down any damage if found.

## 4.2 Installation

Open the box, remove the packing materials, and carefully lift out the device and accessories. Check the included accessories.

The device has to stand horizontally on a steady and even surface.



Install the device in a place where it will not block the working area and the functionality (take the dimensions into account). Make sure that there are about 10 cm of free space on each side to guarantee air circulation (heat dissipation).



Do not install the unit outdoors or in places without proper ventilation.

Before start-up, be sure the device reaches room temperature.

## 4.3 Storage

If the unit is to be stored for an extended period, protect it from moisture and dust.

# 5 Installation / Start-up



**Before** starting the unit, connect up the following:

- Remove the closing plugs from the connections and dosage head.

**Finally**, insert the power plug into the socket, making sure that the mains and the unit operate on the same voltage.



### 5.1 When using 2 litre material containers (included):

 Fill the material container with the relevant component.

**Warning: Insert the container filled with coloured silicone compound – component B – into the colour marked entry at the back of the device. Do not mix up!** If you mix up the closings even for a short time, the device must be disassembled and cleaned.

**Very important:** Do not tighten the caps of the material containers, but just fit them loosely to ensure proper ventilation.

### 5.2 When using 1 kg bottles:

 Remove the closings of the bottles filled with two component silicone and screw the above mentioned metal quick closings (accessories) onto the bottles.

**Warning: Screw the colour marked quick closings onto the bottles filled with coloured silicone compound – component B. Do not mix up!** If you mix up the closings even for a short time, the device must be disassembled and cleaned.

Insert the bottles with quick closings into the entry on the back of the device (the bottles will be upside down).

**Very important:** Drill a ventilation hole using a drill or similar tool at the upper side edge of the bottles to ensure proper ventilation.

### 5.3 When using 6 kg bulks:

 Remove the closings from the cans filled with two component silicone and screw the adaptor set onto the cans.

**Warning: Screw the colour marked adapter onto the can filled with coloured silicone compound – component B. Do not mix up!** If you mix up the closings even for a short time, the device must be disassembled and cleaned.

Insert the can with quick closings into the entry on the back of the device (the can will be upside down).

**Very important:** Drill a ventilation hole using a drill or similar tool at the upper side edge of the can to ensure proper ventilation.

#### 5.4 When using 25 kg bulks:

 Note that while using bulk containers, the cans must be positioned at a height higher than the device. Optional pad stands are available on request.

Remove the closings from the cans filled with two component silicone and screw connection hoses onto the cans.

**Warning: Screw the colour marked connection hose onto the can filled with coloured silicone compound – Component B - screw on. Do not mix up!** If you mix up the closings even for a short time, the device must be disassembled and cleaned.

Place the can, e.g. on the optional pad stand, to make sure that it will be placed higher than the dosage device (can will be upside down) and insert the connection hoses with quick closings into the entry on the back of the device.

**Very important:** Drill a ventilation hole using a drill or similar tool at the upper side edge of the can to ensure proper ventilation.

#### 5.5 Replacing bottles/cans:

Remove the quick coupling/bottle adaptor from the device by pulling up the lock. Screw the quick coupling/bottle adaptor onto the new bottle/can and connect as explained above.

 Take special care to never confuse the bottles or connection hoses A+B – not even for a short time – since the silicone within the connections and pipes hardens instantly! The cleaning procedure is very demanding and may only be performed by authorised repair companies.

Note that while using bulk containers, the cans must be positioned at a height higher than the device. Optional pad stands are available on request.



**Never use with a hardened mixing cannula!**

## 6 Operation

### 6.1 General operating instructions

All instructions for using the unit, whether in verbal or written form, are based on our own experience and experimentation and can only be regarded as guidelines.



Switch on the device; the toggle switch lights green.

To clean the pipes and dosage pump, perform the following upon **first start-up** \* as well as when replacing the bottles: Position a container under the mixing head without the mixing cannula, press the red button and hold it until both components run evenly and without bubbles from the mixing cannula adaptors.

**\* the unit will be delivered with a testing-liquid filled in**

Mount the mixing cannula by turning it 90° on the mixing cannula adaptor (clean the adaptor before if necessary). Place the bowl or the model to be used for doubling the system under the mixing cannula. Press the red button: 1:1 mixed silicone runs out of the mixing cannula.

We recommend collecting a small amount of the mixture initially output and just letting the substance output subsequently run into the form. You can fill more forms without changing the mixing cannula as long as the period between the single dosage operations lies within the dripping time of the used silicone (about 4 min.). The dosage machine 1:1 dispenses mixed silicone as long as you press the red button.

After use, leave the mixing cannula attached to the device and allow the remaining silicone to vulcanise. This closes the openings of both components sufficiently.



A new mixing cannula has to be fitted after hardening and before further usage.

**WARNING: Never use with a hardened mixing cannula!**

**Very important:**

Do not continue operation if one or both containers are empty; otherwise the pipes will convey air (observe the minimum liquid level of the containers: ~ 2-3 cm!).

## 7 Troubleshooting

Problem	Cause	Remedy
No silicone output.	Hardened material within the old cannula.	Mount a new mixing cannula.
No silicone output.	Mixing head clogged.	Clean mixing head carefully. Warning: Silicone components must not get in contact with each other!
No silicone output.	A and B component was mixed up; silicone within the device system has hardened.	The device needs to be disassembled and cleaned by a qualified technician.
No silicone output.	Minimum liquid level of the silicone containers was reached; system has sucked in air.	Add silicone compound and wait about 20 min. until silicone fills the pipes. Position a container under the mixing head without the mixing cannula, press the red button and hold it until both components run out even and without bubbles from the mixing cannula adaptors. Clean the mixing head and connect a new mixing cannula if necessary.
Silicone output without 1:1 ratio.	Silicone components do not have similar viscosity.	We recommend using Wassermann doubling silicones WaSil soft and WaSil.
Silicone output without 1:1 ratio.	Gears within the pump are not evenly worn.	The device needs to be inspected by a qualified technician.



If the above recommendations do not solve the problem, contact your dental depot or our service department.

## 8 Care and maintenance

### 8.1 Cleaning



Disconnect the power plug before starting any maintenance work.

The identification plate has always to be kept in easily legible condition and has not to be removed.



Remove external dirt from time to time with some form of cold cleaner.

Use only cold cleaners to avoid damaging the paintwork or removing the lettering.

The equipment should be cleaned at regular intervals to ensure trouble-free operation. It requires only normal cleaning (sponge, damp cloth, mild detergent) and no further chemical additives.

Always keep the mixing cannula adaptor and the quick closings clean.

### 8.2 Maintenance

The unit does not require any servicing. Just make sure that the device is kept clean.

### 8.3 Repairs



Servicing or repairs to the unit has only to be carried out by qualified technicians.

Only original spare parts are to be used. Responsibility for the product is voided if unauthorised persons alter it or if inappropriate components are installed.

## 8.4 Spare parts

If necessary please contact our service hotline phone:

0049 (0)40 / 730 92 6-0

## 8.5 Scope of delivery / Accessories

Incl. in delivery	Item no.:
Set material cask incl. quick fitting coupling, 2 x 2 liter	172640
Mixing canulas, pink, 100 pcs.	622002
Stand small for duplicating silicones, 2 x 6 kg-cask	172631

Accessories	Item no.:
Foot-operated switch	174175
Conversion kit for foot-operated switch	172630
Set material cask with quick fitting coupling, 2 x 2 liter	172640
Stand small for duplicating silicones, 2 x 6 kg-cask	172631
Stand tall for duplicating silicones, 2 x 25 kg-cask	172632
Connecting tubes cpl., 2 pcs.	172633
Adapter-set for duplicating silicones, 2 x 1 kg-cask	172634
Adapter-set for duplicating silicones, 2 x 6 kg-cask	172636
Mixing canulas, pink, 100 pcs.	622002

## 8.6 Warranty

 The warranty period for our equipment is 12 months. If faults occur within the warranty period, contact your dental depot or get in touch directly with our service department.

Your equipment should only be operated in perfect condition. If faults occur which could harm operators or third parties, the unit should not be used until it has been fixed.

This warranty does not cover damage caused by improper use, external mechanical causes, transport damage or interference with the unit by unauthorized persons.

## 9 Technical data

<b>Sidomix</b>	<b>Item no.: 172984 / 172982*</b>
Voltage*	220–240 V / 50/60 Hz / 110–120 V / 50/60 Hz*
Power consumption	1.6 A
Output	260 W
W x H x D incl. bracket	290 x 310 x 450 mm
W x H x D without bracket	200 x 310 x 440 mm
Weight	11.5 kg
Sound level	≤ 70 dB (A)

\*Other voltages on request

The noise level of the unit amounts to ≤ 70 dB(A).



The technical data are subject to change without prior notice.



**10 EC Conformity Certificate**

in accordance with 2006/95/EG (low-voltage guidelines) and 2004/108/EG (EMV guidelines) and 2006/42/EG (machinery guidelines)

Manufacturer: W A S S E R M A N N      Product description: Mixing and dosing  
Dental-Maschinen GmbH      unit, 1:1, for  
Rudorffweg 15 - 17      dental  
D-21031 Hamburg      applications

Model: Sidomix      Item no. 172984  
Item no. 172982

Applicable standards: DIN EN 61010-1  
DIN EN 61000-6-3  
DIN EN 61000-6-1  
DIN 45635-1  
DIN EN 60335-1

Hiermit wird bestätigt, dass die oben bezeichnete Maschine den genannten EG-Richtlinien entspricht. Diese Erklärung wird ungültig, falls die Maschine ohne unsere Zustimmung verändert wird.

This is to confirm that the above mentioned machine complies with the described EC rules. This declaration becomes invalid if the machine is modified without our approval.

Cette machine est conforme aux normes en vigueur de la Communauté Européene. Cet avis est nul et non avenant si cette machine est modifiée sans notre accord.

Esta máquina, anteriormente mencionada, cumple con los límites requeridos por el reglamento EC. Ahora bien, esta declaración quedará invalidada en caso de realizar modificaciones al aparato sin nuestra aprobación.

Hiermee wordt bevestigd dat bovengenoemde machine voldoet aan de voorgeschreven EU normen. Deze verklaring verliest geldigheid als er zonder onze uitdrukkelijke toestemming wijzigen aan de machine worden aangebracht.

Place, date: Hamburg, 09.01.2013

Company stamp:



Signature : \_\_\_\_\_  
Wilfried Wassermann  
(Managing Director)

**11 Spare part diagram**

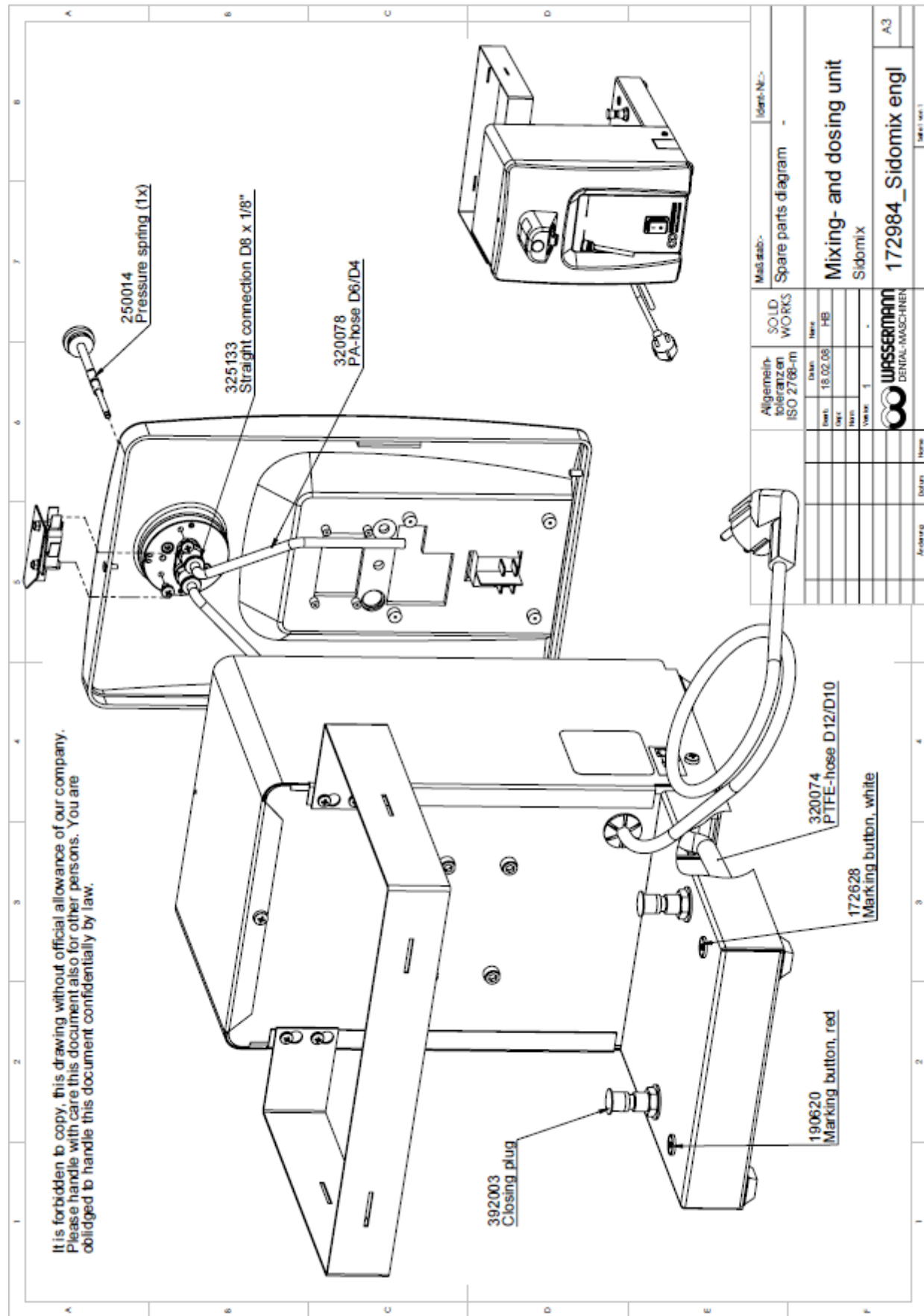



Wassermann Dental-Maschinen GmbH  
Rudorffweg 15-17 · D-21031 Hamburg  
Tel.: +49 (0)40 730 926-0 · Fax: +49 (0)40 730 37 24  
info@wassermann-dental.com